

welcome to st thomas & st james church WORSBROUGH

Welcome to our church. Since its opening in 1859, St Thomas, as it was then known, has featured as a beacon for people. Generations of families have been baptised, worshipped and married here and had its bell toll for their passing.

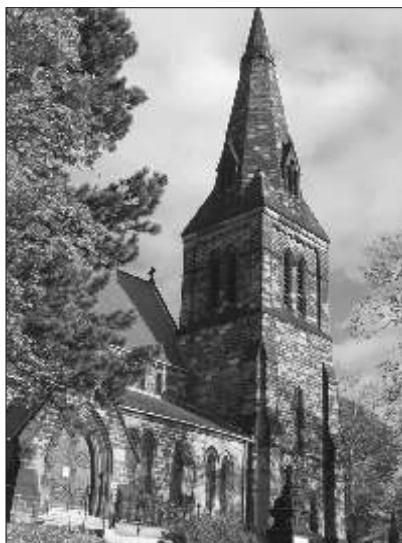

Known in the area as 'St Thomas' or 'St Toms', the foundation stone was laid in 1857, the church built in 1858, then consecrated in 1859. The Wentworth family of Wentworth Castle gave a donation of £2,000 with a promise of a further £1,000. Other people provided donations of smaller amounts or helped in other ways such as John Jeffcock who made the site available. The church was built of stone supplied by Mr Joseph Mitchell who rented a quarry owned by Mr Jeffcock. The total cost of the church building was about £3,000.

The building differs from the original plan. The original intention was for it to have a chancel, one principal aisle and one south aisle. It was felt that the building would not be big enough to accommodate the local population at the time so an additional aisle was added to the north. Many local families provided for the equipping and furnishing of the church.

The Font (1)

As you enter the church through the south porch, you will see straight ahead of you a stone bowl called the font. It holds the water used in baptism. Baptism is a time when babies, children and adults are welcomed into the church family. There are some words, still legible, engraved around the top rim: 'One Lord, one faith, one baptism'.

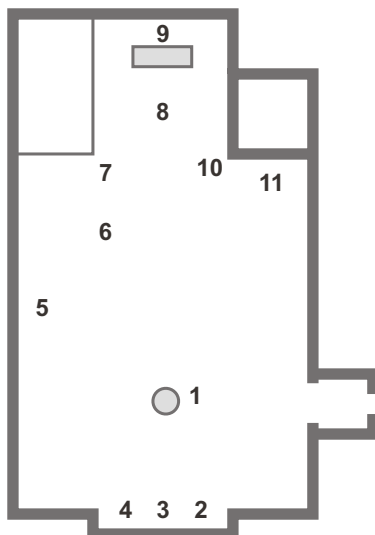

This stone font replaced the original font that is said to have been carved from coal from the Darley Colliery and lined with glass. Unfortunately, this font began to crack and was eventually replaced (in 1879) by the font of Caen stone presently in use. The candle near the font is called the Paschal Candle. It is lit to remind us that Jesus is the Light of the World. Notice the Alpha and Omega symbols on the candle that represent the beginning and the end.

Ten Commandments (2)

The Ten Commandments is painted on two metal panels. They were originally located behind the altar.

West Window (3)

This window shows scenes from the Gospel accounts of the life of the apostle Thomas. It was a gift of the Jeffcock family. Both windows were the work of Messrs. Barnett & Co of Leith. Just below are the choir stalls that were moved from the chancel in the 1950's. Notice the fine carvings on the side of the pews.

Creed and Lord's Prayer (4)

Like the Ten Commandments, these are also painted on two metal panels and were originally located behind the altar.

Carved Caen Stone Tablet (5)

This was a gift from St James Church when closed in 1973. Following mining subsidence, St James was sold to the Roman Catholic church. Notice the memorial plaque further down the aisle.

Print and Flower Holder (6)

The framed picture and brass flower holder attached to the column in the nave were given to the church by Nurse Mortimer, thought to be in memory of her husband - William Charles Mortimer, who died in 1939. Nurse Mortimer was the midwife for Worsbrough and sat in the pew below the picture.

The Pulpit (7)

The pulpit was provided by the Cooper family in 1866. The five panels contain carved figures illustrating Peter, Jesus blessing the children, the Sermon on the Mount, John the Baptist and an Angel holding a scroll. The work on the pulpit is by the Dublin Company of Early & Powell.

The Chancel (8)

There are several memorials on the south side wall, including a memorial to the first vicar, Canon William Banham, who served Worsbrough for 62 years. There is a fine wall painting that is thought to be of Moses followed by some of the main characters of the Bible, finishing with Joseph and Mary carrying baby Jesus. The reredos is a stone carving behind the altar, with the centre inlaid with marble mosaic.

The East Window (9)

Above the reredos is the fine East Window, given by the Revd John Newman and family. The centre light shows a representation of the Crucifixion with, on either side, 'The Raising of Lazarus' and 'The Resurrection', 'The Brazen Serpent' and 'The Offering of Isaac'.

One interesting feature that was discovered in later years is that the text references relating to the two outer lights of the East Window were evidently transposed during the manufacture of the window. The sanctuary lamp was placed in 1935. If you look up, on the cornices you can see decorated shields with symbols of the Passion of Christ. They date from 1905.

The Lectern (10)

The lectern is a beautifully carved eagle which represents the spread of God's word.

Side Chapel (11)

This chapel is available to use for private prayer. As you walk down the north aisle, see the wooden plaque with the list of Vicars who have served the Parish.

The Tower and Bells

The tower, made of coarse York stone, has a brooch spire. There is one bell which was cast in London in 1860 and cost £80. The bell was rehung with a new steel frame and girders in 1983.

The Graveyard

The graveyard around the church is closed to new burials and contains some family tombs. Near the front porch of the church is the memorial to the Swaithe Pit disaster. Across the road there is a burial site which is also closed to new burials. Both sites contain war graves.

Prayer

Heavenly Father we thank you for this place where faithful Christian people came to worship here for many generations. We thank you for those whose lives and ministry shared the love of God. As we think of all those who have gone before, we also remember that this church is a living church now. We pray for its present and its future in the community, as a light shining in the years to come and encouraging many to hear the story of Jesus and respond to your love in their lives.

Amen.

We hope that you have enjoyed your time at St Thomas.

St Thomas Church is a landmark in the area and in the lives of the generations of people who entered here in worship and prayer, with their hopes and their fears, their joys and their sorrows.

Before you leave, please sign the Visitor's Book.

Services

Services are held here every Sunday morning at 9.30am.

Every third Sunday is Morning Prayer and Baptism.

Every other Sunday is Holy Communion.

You are welcome to join us for refreshments which are served in the hall across the road after each service.

For more information please phone Revd Trevor Keightley on 01226 286505.

You should find us if you visit the website 'A Church Near You' and type in 'St Thomas and St James, Worsbrough'.



Text & Plan: Revd Trevor Keightley

Design: HERITAGE INSPIRED (www.heritageinspired.org.uk)

